

RETENTION POND EMERGENCY SPILLWAY
NOT TO SCALE

FRONT ELEV. FLARED END

PLAN OF FLARED END

FLARED END SECTION

NOTE:
GROUTED RIP-RAP TO EXTEND UP CHANNEL SIDES
AT A MAX. SLOPE OF 2:1 TO A HEIGHT EQUAL TO
ONE HALF THE PIPE DIA. OR GREATER

DIMENSIONS (INCHES):							
I.D.	12	15	18	21	24	27	30
A	2	2 1/4	2 1/2	2 3/4	3	3 1/4	3 1/2
R	5	7 1/2	9	9	10	10	14
S	24	24	24	24	24	24	26
T	24	24	24	24	24	24	30
U (FT)	4	4	4	4	4	4	4'-8"
V	24	28	34	40	48	54	60

NOTE:
MINOR VARIATIONS TO THE ABOVE DIMENSIONS ARE ACCEPTABLE
WITH THE EXCEPTION OF THE INSIDE DIAMETER DIMENSION.

PLAN

SECTION A-A

ANTI - SEEP COLLAR DETAIL

D	a	A	G	F	H
18"	30°	18"	45"	7'-4"	5'-8"
24"	30°	21"	60"	9'-2"	6'-3"
30"	45°	24"	75"	16'-6"	6'-10"
36"	45°	27°	90"	19'-6"	7'-6"
42"	45°	30"	105"	22'-6"	8'-2"
48"	45°	33"	120"	25'-6"	8'-9"

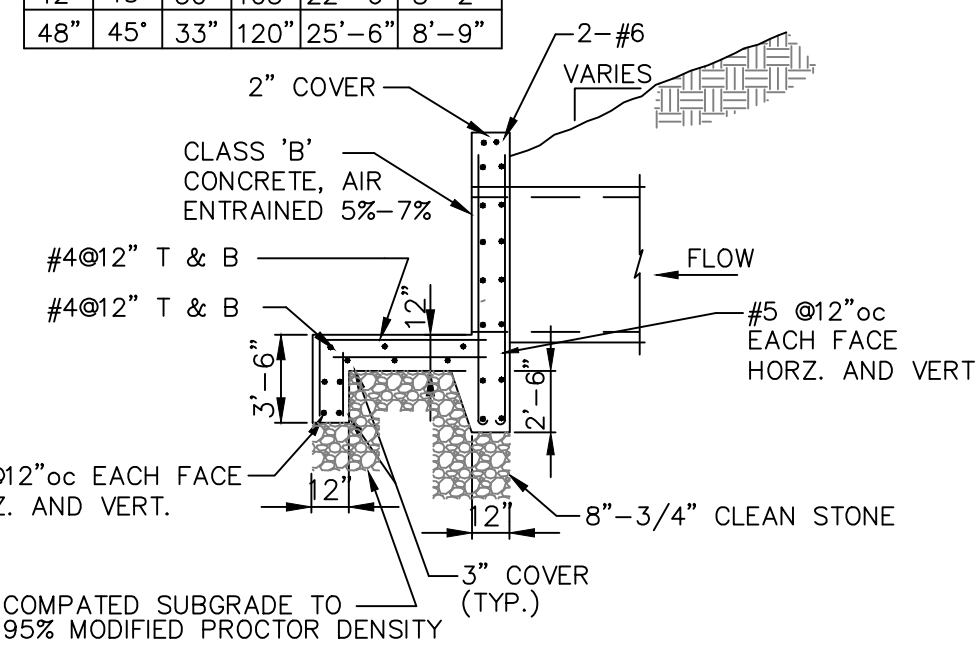

CONCRETE HEADWALL
NOT TO SCALE

VEGETATED SWALE SECTION
NOT TO SCALE

VEGETATED SWALE PROFILE SECTION
NOT TO SCALE

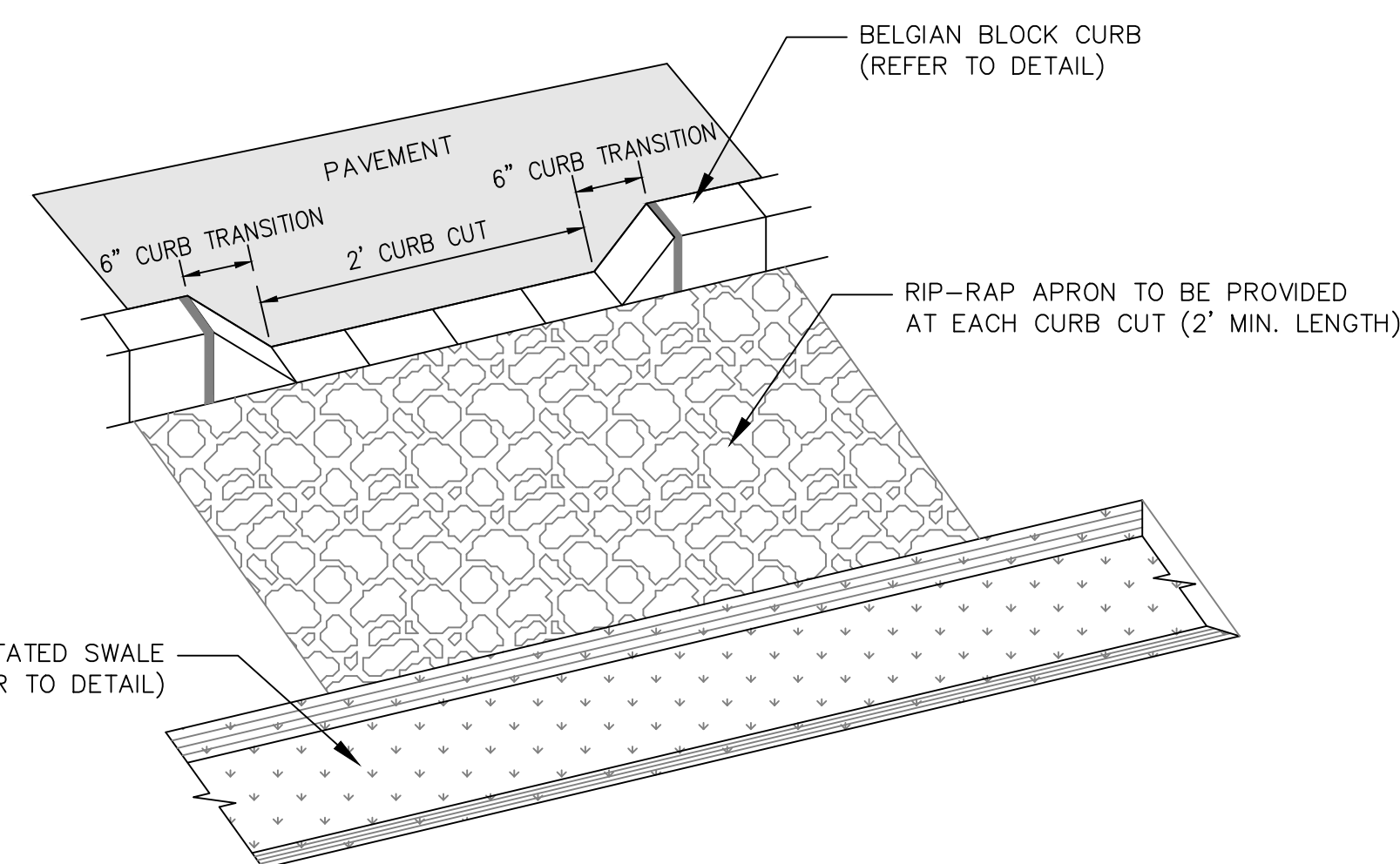

NOTES:
CURB CUTS TO BE PROVIDED EVERY 50' (OR AS
REQUIRED). REFER TO SITE PLAN FOR CURB CUT
LOCATIONS.

CURB CUT DETAIL
FOR VEGETATED SWALE
NOT TO SCALE

DAYLIGHT ROOF DRAIN
NOT TO SCALE

DAYLIGHT ROOF DRAIN (OPTIONAL)
NOT TO SCALE

SECTION

Structure Symbol	Structure Type	Q (cfs)	Pipe Diam. Di (ft.)	Tailwater (ft.)	d ₅₀ (in.)	d _{max} (in.)	Apron Length La (ft.)	Apron Width W (ft.)*	Blanket Thickness (ft.)	NYS-ESC Reference
A-HW	Conc. Headwall	1.05	18	0.00	6	9	9	11	14	Fig. S 5B12
A100-HW	Conc. Headwall	10.28	30	1.25	6	9	10	7	11	Fig. S 5B13
A200-HW	Conc. Headwall	6.32	15	0.50	6	9	8	9	14	Fig. S 5B12
A300-HW	Conc. Headwall	2.67	15	0.50	6	9	8	9	14	Fig. S 5B12
A400-HW	Conc. Headwall	1.28	15	0.50	6	9	8	9	14	Fig. S 5B12
A500-HW	Conc. Headwall	1.03	15	0.50	6	9	8	9	14	Fig. S 5B12
A600-HW	Conc. Headwall	2.56	15	0.50	6	9	8	9	14	Fig. S 5B12
B-HW	Conc. Headwall	0.94	18	0.00	6	9	9	11	14	Fig. S 5B12
B100-HW	Conc. Headwall	17.85	24	1.00	8	12	10	5	17	Fig. S 5B13
B400-HW	Conc. Headwall	27.51	24	0.75	6	9	16	18	14	Fig. S 5B12
B500-HW	Conc. Headwall	2.51	18	0.50	6	9	9	11	14	Fig. S 5B12
B900-HW	Conc. Headwall	1.77	18	0.50	6	9	9	11	14	Fig. S 5B12
B700-HW	Conc. Headwall	3.11	18	0.50	6	9	9	11	14	Fig. S 5B12
C-HW	Conc. Headwall	15.35	18	0.50	6	9	9	11	14	Fig. S 5B12
C100-HW	Conc. Headwall	39.55	30	1.50	6	9	18	10	14	Fig. S 5B13
C400-HW	Conc. Headwall	10.25	24	0.75	6	9	12	14	14	Fig. S 5B12
D-HW	Conc. Headwall	4.61	18	0.50	6	9	9	11	14	Fig. S 5B12
D100-HW	Conc. Headwall	17.31	24	1.00	6	9	9	6	14	Fig. S 5B13
E-HW	Conc. Headwall	0.38	18	0.00	6	9	9	11	14	Fig. S 5B12
E100-HW	Conc. Headwall	10.31	24	1.00	6	9	8	5	14	Fig. S 5B13
E300-HW	Conc. Headwall	2.76	15	0.50	6	9	8	9	14	Fig. S 5B12
E400-HW	Conc. Headwall	1.49	18	0.50	6	9	8	9	11	Fig. S 5B12
E500-HW	Conc. Headwall	1.10	15	0.50	6	9	8	9	14	Fig. S 5B12
E600-HW	Conc. Headwall	3.75	18	0.50	6	9	9	11	14	Fig. S 5B12

*Apron Width W=L+D₅₀ (Fig. S**5B12**, Minimum Tailwater Condition, Tw=0.5d₅₀)

RIP-RAP CONDUIT OUTLET PROTECTION

It is a violation of NYSE Education Law, Article 14 Section 7200.2, for any person, unless he is acting under the direction of a licensed professional engineer or land surveyor, to prepare, or cause to be prepared, any drawing or map for use in connection with the construction of any building, structure, or work of engineering or land surveying. If the drawing or map is altered, the drafting engineer or land surveyor shall affix to the item a statement of the nature of the alteration, the signature and the date of such alteration, and a specific description of the alteration.

ALL DIMENSIONS MUST BE VERIFIED BY THE CONTRACTOR. NOTIFY PAULUS, SZOKOLSKI AND SARTOR OF ANY CONFLICTS, DISCREPANCIES OR DISCREPANCIES IN THE CONTRACT DOCUMENTS. THE CONTRACTOR SHALL BE RESPONSIBLE FOR THE ACCURACY OF ALL DIMENSIONS SHOWN BE AS NOTED IN WORDS OR NUMBERS ON THE CONTRACT DRAWINGS. DO NOT SCALE THE DRAWINGS TO DETERMINE DIMENSIONS.

THE CONTRACT DRAWINGS CONTAIN DATA INTENDED SPECIFICALLY FOR THE NOTED PROJECT. ANY OTHER USE OF THESE DRAWINGS OR ANY PART THEREOF FOR ANY OTHER PROJECT OR FOR REUSE ON ANY OTHER PROJECT IS PROHIBITED.

THE COPYING AND/OR MODIFICATION OF THIS DOCUMENT ON ANY PORTION THEREOF WITHOUT THE WRITTEN PERMISSION OF PAULUS, SZOKOLSKI AND SARTOR IS PROHIBITED.

COPYRIGHT 2016 PAULUS, SZOKOLSKI, AND SARTOR - ALL RIGHTS RESERVED.

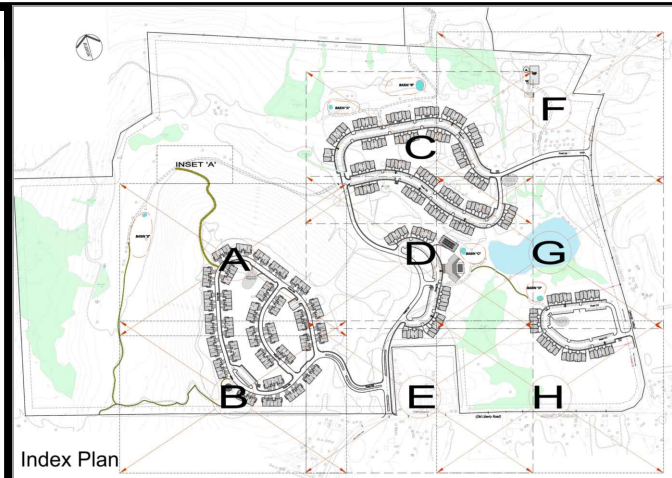

CONSULTANTS

PS&S
integrating design & engineering

67A MOUNTAIN BOULEVARD EXTENSION
P.O. BOX 4039
WARREN, NEW JERSEY 07059
PHONE: (732) 560-9700
FAX: (732) 560-9768

LISA A. DIGEROLAMO, P.E.
PROFESSIONAL ENGINEER
NEW YORK LIC. NO. 086749

7/1/2016

SIGNATURE DATE

[illegible]

PROJECT TITLE

PRELIMINARY & FINAL SITE PLAN

Gan-Eden Estates

TOWN OF THOMPSON SULLIVAN COUNTY NEW YORK

TAX LOT
SECTION 2,
BLOCK 1/ LOT 6.3

STORMWATER DETAILS

INITIAL DATE	12/04/2015	JOB NO.	01895/0053
SCALE	AS SHOWN	B/O	
DRAWN	CY/FM	SHEET NO.	
CHKD.	AG/LAD		C-15 69 OF 79